

CD72SR Series Disc Traps

For Steam Service up to 1010 psig (69.6 barg) and Capacities from 935 lb/hr (435 Kg/hr)



Armstrong CD72SR is a disc styled trap designed to control the trap's cycle rate. The reduced cycle rate provides Armstrong CD72SR trap with a longer service life than typical disc traps. This enhanced performance ensures minimum maintenance time and reduced steam costs.

The capacity of Armstrong CD72SR has been engineered specifically for the following applications: large steam main drips, process equipments and HVAC heating equipments at constant pressure.

Advantages of CD72SR

- Minimum wear with controlled cycling
- Freeze-resistant
- Hardened Seat and disc
- Weldable
- In-line repairable

Connections

Screwed BSPT and NPT Socketweld
Flanged DIN or ANSI (Welded).
Consult factory for dimensions and weight

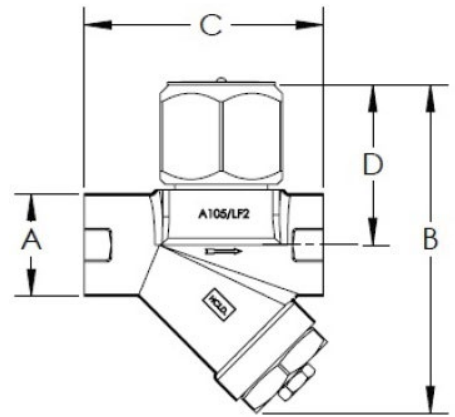

List of Materials	
Name of Part	Material
	CD72SR
Body	Dual certified Forged Corten Steel
Cap	ASTM A 105N / A350 LF2 Cl. 1
Disc & Seat	ASTM A 564 TYP630, H900
Strainer Screen	Stainless steel TYP304, 30 x 30 Mesh
Screen Retainer	Dual certified Forged Corten Steel ASTM A 105N / A350 LF2 Cl. 1
Blowdown Plug	ASTM A350 Gr. LF2 CL.1

Dimensions and Weights				
Model No.	CD72SR			
	1/2" and 3/4" (DN 15 DN20)		1" (DN25)	
	in	mm	in	mm
"A"	1.53	38.8	1.89	48.0
"B" Height	4.89	124.1	5.12	130.0
"C" Length	3.56	90.5	4.41	112.0
"D" \varnothing to top of cap	2.38	60.5	2.58	65.6
Weight, lb (Kg)	3.31 (1.5)		4.59 (2.0)	
Max. allowable pressure (Vessel Design)	1010 psig @ 750°F (69.6 barg @ 399°C)			
Min. operating pressure	3.5 psig (0.24 barg)			
Max. operating pressure	600 psig @ 486°F (41.4 barg @ 252°C)			

Designs, materials, weights and performance ratings are approximate and subject to change without notice. Visit armstronginternational.com for up-to-date information.



CD72SR Series Disc Traps

For Steam Service up to 1010 psig (69.6 barg) and Capacities from 935 lb/hr (435 Kg/hr)

CD72SR CAPACITY CHART

Capacities given are in continuous discharge capacities in pounds and kilograms of hot condensate per hour at pressure differential indicated with condensate temperatures approximately 25° F (14°C) below steam temperature.

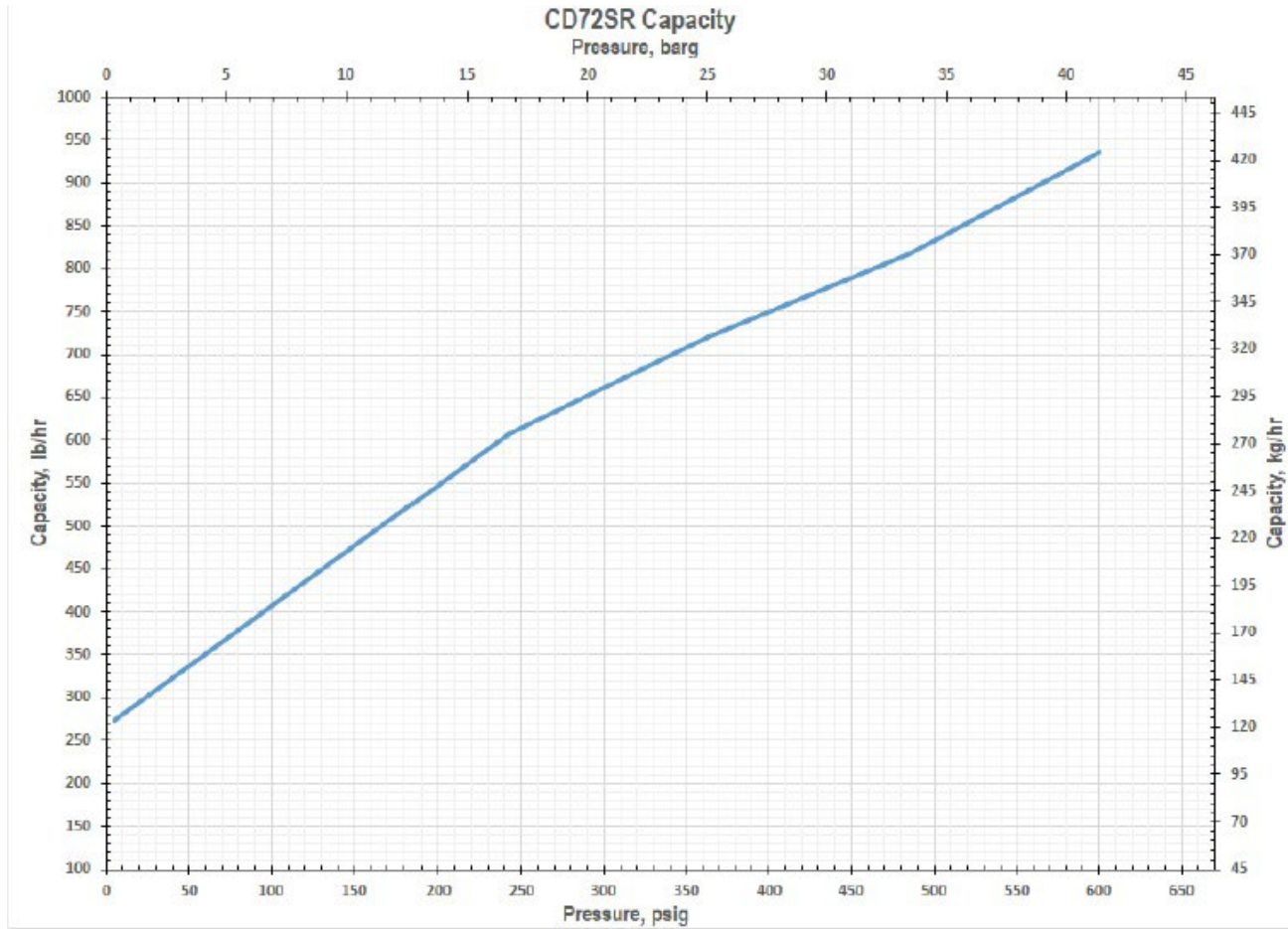

OTHER FACE TO FACE DIMENSIONS ARE AVAILABLE ON REQUEST

CD72SR	1/2"(DN15)				3/4"(DN20)				1"(DN25)			
	inch	mm	INDIA - IBR		inch	mm	INDIA - IBR		inch	mm	INDIA - IBR	
			inch	mm			inch	mm			inch	mm
ANSI 150#	6.7	169	8.3	210	6.9	174	7.9	200	7.9	200	8.7	220
ANSI 300#	7.0	179	8.8	224	7.2	183	8.7	220	8.4	213	9.4	240
ANSI 600#	7.6	192	9.3	235	7.7	195	9.1	230	8.9	226	10	253
PN40	5.9	150	-	-	5.9	150	-	-	6.3	160	-	-