

ARMSTRONG'S TT-2000

THERMOSTATIC STEAM TRAP WITH 360° UNIVERSAL CONNECTOR

One of Armstrong's line of labor saving stainless steel steam traps

Now Armstrong offers a variety of steam traps that bring you easy, in line renewability. The TT-2000 is a balanced pressure, bellows-type thermostatic trap in a sealed, lightweight stainless-steel body. Its phosphor bronze bellows discharges at slightly below steam temperature over the entire pressure range — no adjustments are required.

Versatility

The TT-2000 is piped in line by a 360° universal connector which allows you to install the trap in virtually any piping configuration. This connector makes your TT-2000 interchangeable with Armstrong's CD-2000 disc steam traps and Series 2010 inverted bucket steam traps.

Labor Saving

Armstrong's unique connector makes the TT-2000 easy to install, easy to renew. You save on labor time and cost because the connector simplifies piping and remains in-line. The trap body is attached to the connector by 2 bolts. The TT-2000 can be replaced in ½ hour as compared to 2½ hours for non-in-line replaceable traps. That amounts to an 80% savings on replacement labor costs.

Corrosion Resistant

The sealed, stainless steel bodied traps with phosphor bronze bellows offer exceptional resistance to corrosion. Phosphor bronze, a high strength alloy, has superior fatigue resistance to assure long life and dependable service. The TT-2000 is guaranteed for one year against defective materials, workmanship, and failure due to wear.

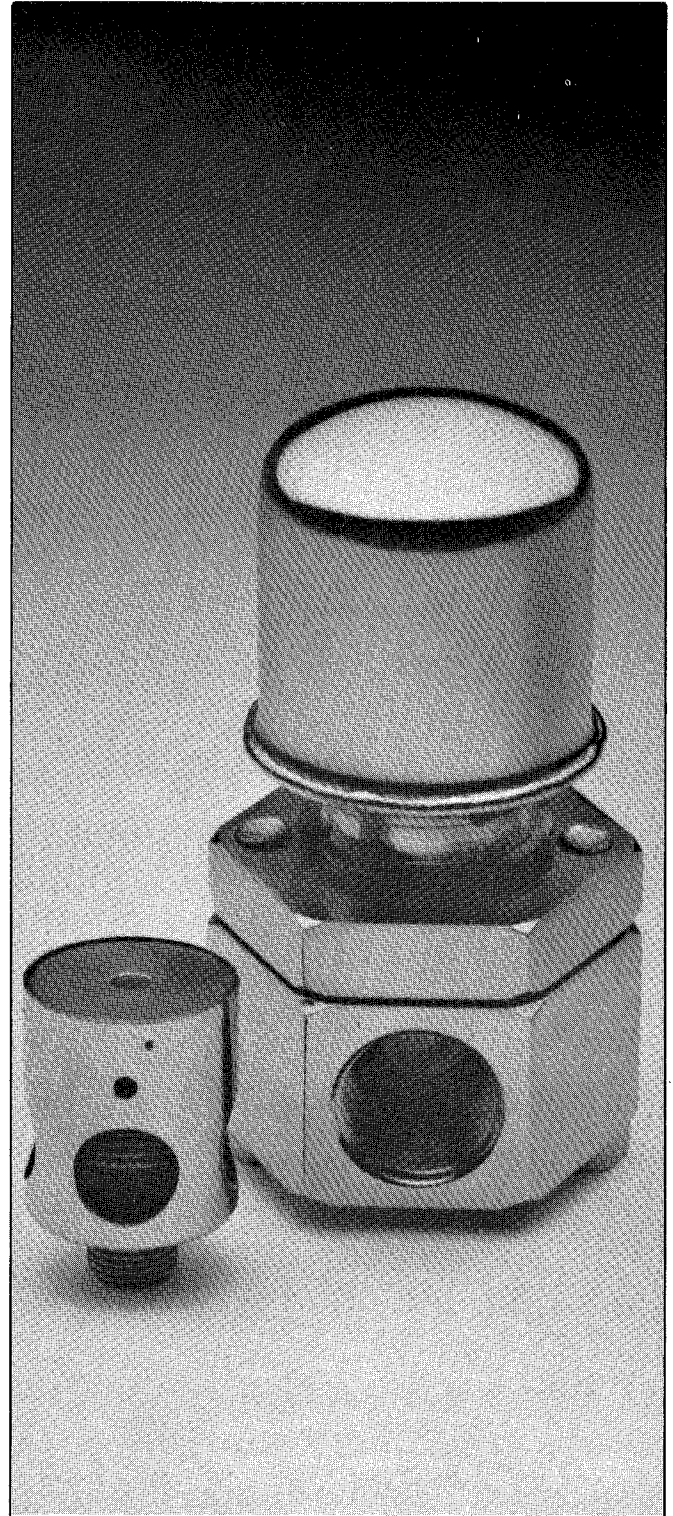

Maximum Operating Conditions

Pressure 300 psig (21 bar)
 Temperature 423°F. (217°C.)

Connections

1/2", 3/4" (15 mm., 20 mm.)
 N PT-BSPT
 Socket Weld

Materials

Body-304L Stainless Steel
 Flange-Nickel plated Carbon Steel
 Connector-304 Stainless Steel
 Bolts-Zinc plated Carbon Steel
 Bellows-Phosphor Bronze Bellows caged in Stainless Steel with Stainless Steel valve and seat.

Capacities

Steam Pressure		Capacity	
psi	bar	lb/hr	kg/hr
5	.3	310	140
10	.7	420	190
15	1.0	550	250
25	2.0	730	330
50	3.5	1050	475
75	5.0	1350	615
100	7.0	1600	725
125	9.0	1800	820
150	10.0	2000	910
175	12.0	2150	975
200	14.0	2350	1065
250	17.0	2650	1205
300	21.0	2900	1320

Capacities are based on condensate temperatures not to exceed 20°F. (11 °C.) below steam temperature.

Allow 1/2" (15 mm.) clearance for trap installation and removal.

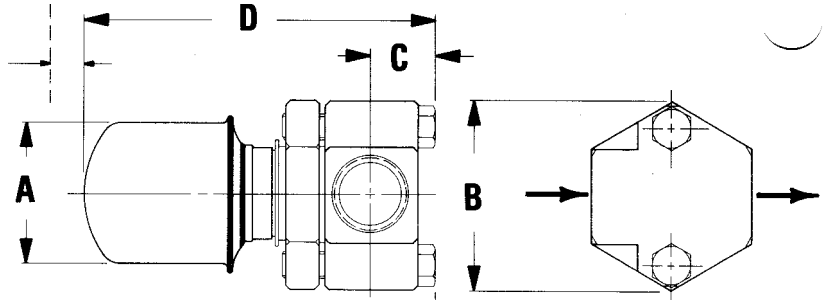

Allow 2 1/2" (65 mm.) clearance for bolt installation and removal.

Dimensions and Weights

A	2 1/4"	57 mm.
B	2 3/4"	70 mm.
C	1"	25 mm.
D	5 1/4"	132 mm.
Discharge Orifice	3/16"	5 mm.
Weight (less conn.)	1 1/2 lbs.	.68 kg.
Weight	3 lbs.	1.36 kg.

Other Steam Traps in the 2000 Connector Series

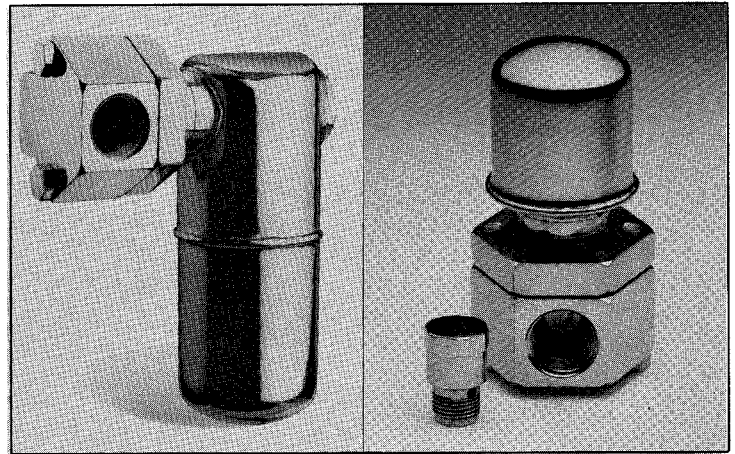

FIG. 1-2011 Inverted Bucket Steam Trap

FIG. 2-CD-2000 Disc Steam Trap



Steam Specialty Products

Armstrong International, Inc.

USA 816 Maple Street, Three Rivers, Michigan 49093 | Phone: (616) 273-1415 ;

Europe Parc Industriel Des Hauts-Sarts, B-4400 Herstal/Liege, Belgium Phone: (041) 480152